

Douglas Hall:

Information available at www.eiu.edu/~housing



More layouts
on back!



Double Room:

[Rooms 1-8, and 10]

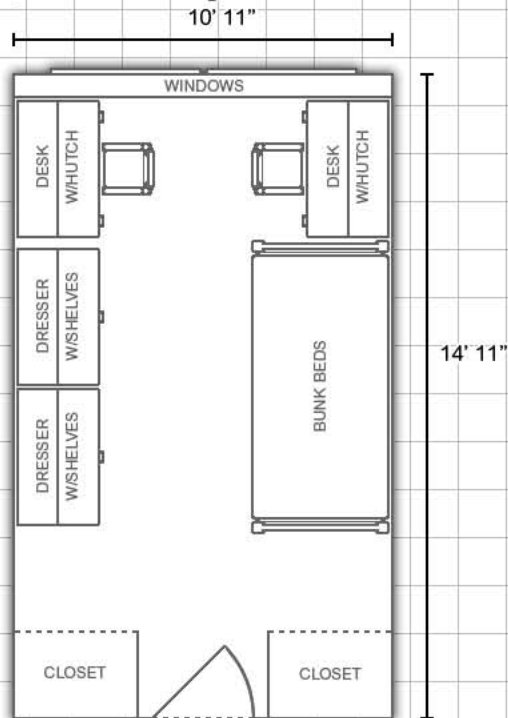

Double Room:

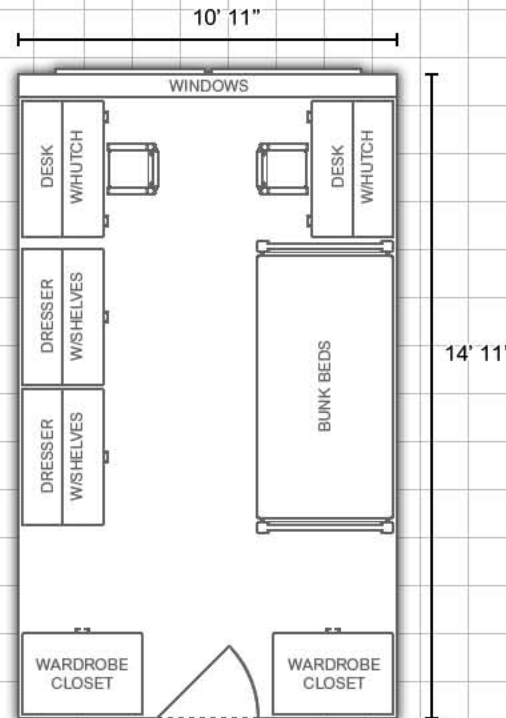

DEPARTMENT:

**Housing and
Dining Services**



EASTERN ILLINOIS UNIVERSITY™

Bedding: Bedding in all rooms measure 80" X 39" (x-long twin)

Furnishings: Rooms are carpeted and feature stackable, loftable and bunkable furniture

Miscellaneous: *Layouts are not to scale*

Triple Room:

