

SUMMER

MAILING ADDRESS CHANGES

- All 1st class mail, with the exception of magazines and other subscriptions, will automatically be forwarded to your permanent address.
- If your permanent address has changed, please update your records with the Registrar's Office in Old Main.
- Update the mailing address of your online shopping such as Amazon, DoorDash, etc., ship-to-home deliveries from Walmart, etc., and credit card companies to your summer mailing address.



Thomas Hall

ROOM FURNITURE

Be sure to move room furniture to the locations defined in the diagram

DESKS

- Set flush with wall
- Hutches are permanently affixed to desks
- Final placement of desks should resemble the diagram(s) shown on this poster

DRESSERS

- Bookcases should be stacked on top of dressers
- Set flush with wall
- Final placement of dressers should resemble the diagram(s) shown on this poster

BEDS

- Should be bunked *
- Guard rails out *
- Set flush with wall
- Set taller section of lower bed frame (A) up, and taller section of top bed frame (B) down
- Final placement of beds should resemble the diagram(s) shown on this poster

* Only applicable in Double Rooms

MAKE SURE TO...

- Use the pins to couple furniture pieces together
- You may request additional pins from your front desk at no charge
- You will not be allowed to check out until all your room furniture is moved to the locations defined in the diagram with the pins in the proper place
- Please be aware that failure to reset your room may result in a \$100 improper checkout charge

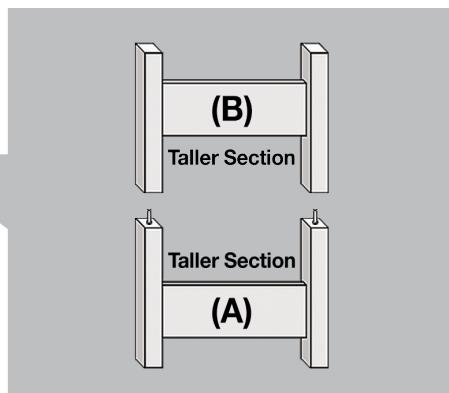

Double Room:

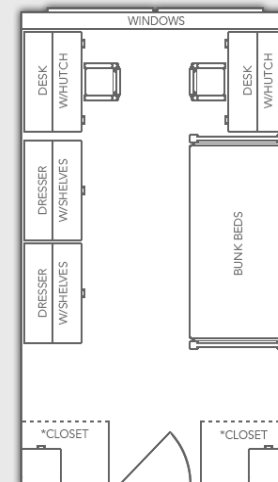

Physical Single Room

Rooms 103, 152, 203, 252, 303, 352, 403, and 452

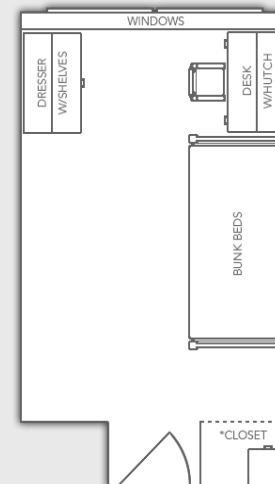

Layouts not to scale.

Housing and Dining Services



EASTERN ILLINOIS UNIVERSITY