

# LINCOLN HALL

Information available at [WWW.EIU.EDU/HOUSING](http://WWW.EIU.EDU/HOUSING)

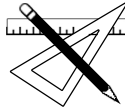

## Double Room: (Closet)

Lower Level and 157, 159, 161 and 163

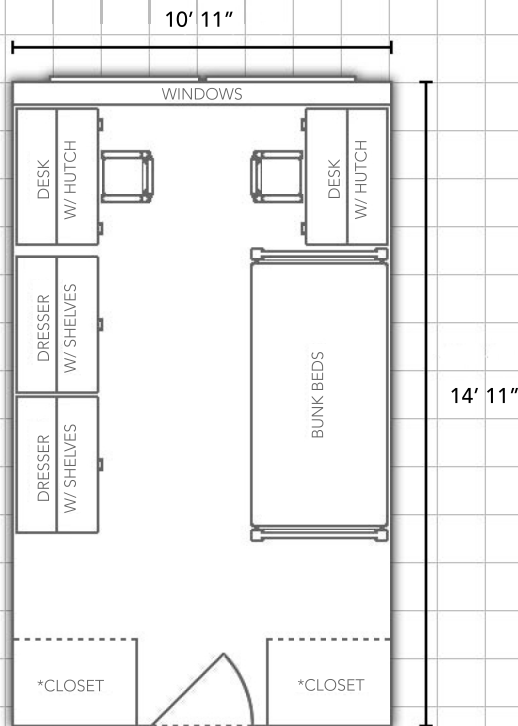

## Double Room: (Wardrobe)

First Floor (except 157, 159, 161, and 163), Second Floor and Third Floor

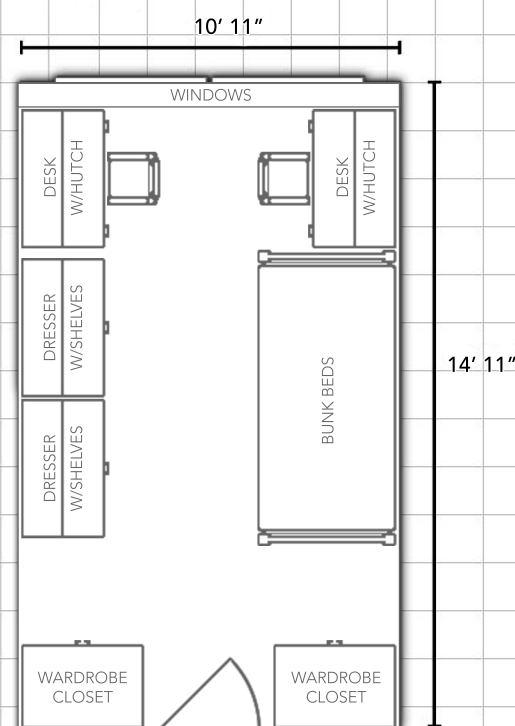

**MORE  
LAYOUTS  
ON BACK!** →

Department:

**Housing and  
Dining Services**



EASTERN ILLINOIS UNIVERSITY

Bedding:

Bedding in all rooms measure  
80" X 39" (x-long twin)

Furnishings:

Rooms are carpeted and feature  
stackable, loftable and  
bunkable furniture

Miscellaneous:

*Layouts are not to scale*

# Triple Room: (Wardrobe)

(Rooms 166, 274 and 374)

