

ROOM FURNITURE

Be sure to move room furniture to the locations defined in the diagram

DESKS

- set flush with wall
- hutches are permanently affixed to desks
- final placement of desks should resemble the diagram(s) shown on this poster

MAKE SURE TO . . .

- use the pins to couple furniture pieces together
- you may request additional pins from your front desk at no charge
- you will not be allowed to check out until all your room furniture is moved to the locations defined in the diagram with the pins in the proper place
- please be aware that failure to properly assemble room furniture will result in a \$25 improper check out charge and a \$20 assembly charge

BEDS

- should be bunked*
- guard rails out*
- set flush with wall
- set taller section of lower bed frame (A) up, and taller section of top bed frame (B) down
- final placement of beds should resemble the diagram(s) shown on this poster

DRESSERS

- bookcases should be stacked on top of dressers
- set flush with wall
- final placement of dressers should resemble the diagram(s) shown on this poster

* Only applicable in Double Rooms.

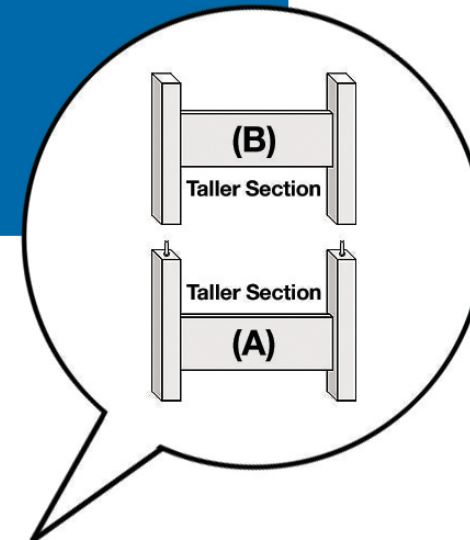

DOUBLE ROOMS

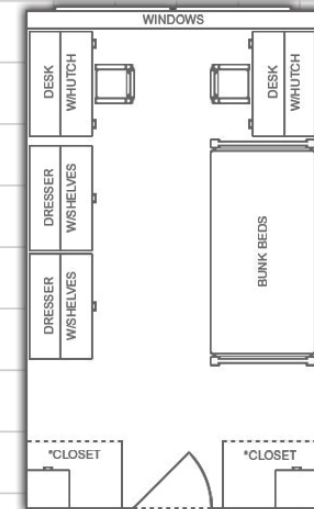

PHYSICAL SINGLE ROOMS (ROOMS 103, 203, 303, 403, 152, 252, 352 & 452)

